

CONTROL UNITS

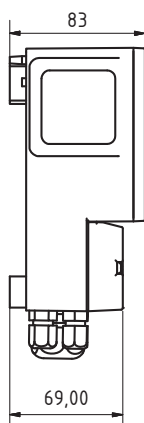

Sequetrol

Programmable controller for small wastewater treatment plants with water-level control without float switch

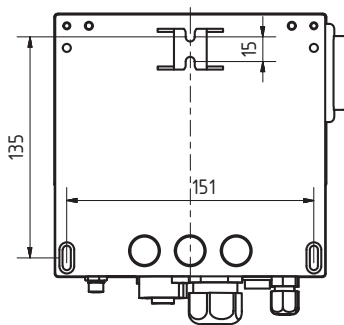
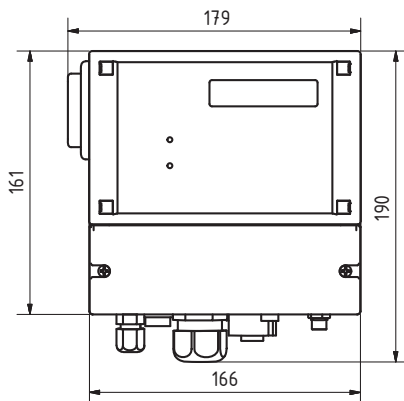

- Easily programmable
- Water-level control for up to 2 tanks using pressure sensors
- Up to 8 + 1 relay outputs
- Individually equipped (display, keypad, connectors) according to customer requirements
- GSM-module as option

Why use the Sequetrol control unit?

- Water-level control without expensive and unreliable float switches means no more electricity carrying parts in the cesspool.
- Easy and accurate monitoring of the water-level & its rate of change
- Reliable technology proven in thousands of installations
- Up to 8 + 1 relay outputs (8 x 230VAC, 1 x low voltage) offer easy connection of accessory devices
- Individually equipped (display, keypad, connectors) according to customer requirements
- Sequence program can be easily created and modified with the PC software MenuMaker
- Password protected operating levels, updateable firmware and software
- Power supply during mains failure for the control and for the GSM-module (failure message) as option

CONTROL UNITS

Sequetrol details

Sequetrol was designed as a comfortable and reasonably priced control unit for small wastewater treatment plants.

Water-level control:

The innovative water-level control utilizing pressure sensors allows cost-effective detection of preset water levels and continuous level measurement without the use of failure-prone float-switches.

Beyond that, the Sequetrol control unit is especially suited for more sophisticated control algorithms particularly where incoming/outgoing water flow or its rate of change is employed as a control variable.

Interfaces and connectors:

The optional analogue input can be utilized for a further optimization of the wastewater treatment process. Properties, such as the turbidity of the treated water can be analyzed.

Up to four external digital signals can be monitored and processed within the control algorithm.

In addition the Sequetrol control can be equipped with an RS-232, RS-485 or a USB bus interface, so other „intelligent“ peripheral devices or control panels can be connected to the system. Up to 8 relay outputs for 230VAC offer a comfortable connection of solenoid valves, diaphragm compressors or other loads.

The optional GSM module can be used to send alarm and status text messages or to receive control commands.

All electrical connections are made using reverse polarity protected plugs with IP54 rating. Of course the type of connectors can be changed according to customer requirements.

Equipment:

The extent of the system functionality and the design of the front panel of the Sequetrol control unit can be tailored to match your individual needs.

We can offer you zero to six push buttons; anything from three LEDs to a graphical LCD display; from a simple sequence control up to an event-driven control system with water-level control utilizing pressure sensors; analog/digital inputs, relay outputs, GSM module and a handy memory stick for programming the control and the readout of the protocols - we are flexible!

The Sequetrol is also available with features, such as, acoustic signaling of predefined conditions, a sequence program permanently stored in the EEPROM and additional EEPROM memory for event-logging. To ensure continuous signaling and operation of the GSM module during power outage a set of NiMH rechargeable batteries can be supplied.

Attribute	Value
ns (l x w x h), weight	83 x 179 x 190 mm; 1,5 kg
Ambient temperature	-20°C bis +55°C
Protection classification	IP 54
Functions, sequence program, alarms, GSMcommunication, display messages (also foreign-languages)	All according to customer request and requirement. Sequence programs are designed and adapted by the wastewater treatment plant manufacturer by means of a clear and easy-to-use PCsoftware.
Display / LED	According to customer request, illuminated (backlit) graphical or alphanumeric LCD, alternatively numeric LED display (e.g. 6-digit) Additionally up to 3 LED (colors as requested)
Signal-input	Up to 4 x digital inputs or a combination of digital and analog (0-10V) inputs
Data interface	RS-232 (optional RS-485)
Electrical output	According to customer request, up to 8 relays 230V / 300VA + 1 x low voltage
Power supply during mains failure	4x mignon batteries, optionally NiMH rechargeable batteries (size AA)
Power supply	230 VAC, 6 VA max.